



LIST OF BEDROOMS & FLOOR PLANS AT SAXTON MANOR

BEDROOMS – sleeps 21 (+4*) in 10 bedrooms

● indicates a choice of bed configuration

Bedroom	Beds	Sleeps	Features
Bedroom 1 (first floor)	Super king size bed	2	Ensuite bathroom with roll top bath and separate shower. TV.
Bedroom 2 (first floor)	Super king size bed	2	Shared Jack and Jill wet room style ensuite shower room (shared with bedroom 9). TV.
Bedroom 3 (first floor)	Super king size bed (can be divided into two single beds) ●	2	Shared family bathroom with bath and separate shower.
Bedroom 4 (first floor)	King size bed, plus single bed	3	Shared family bathroom with bath and separate shower.
Bedroom 5 (second floor)	Double bed	2	Ensuite shower room.
Bedroom 6 (second floor)	Four poster double bed	2	Shared Jack and Jill bathroom with free standing bath (shared with bedroom 7).
Bedroom 7 (second floor)	Super king size bed (can be divided into two single beds) ●	2	Shared Jack and Jill bathroom with free standing bath (shared with bedroom 6).
Bedroom 8 (second floor)	Super king size bed (can be divided into two single beds) ●	2	Access to shared family bathroom on the first floor or shared bathroom on the second floor (note access to the second floor bathroom is via bedroom 7 only).
Bedroom 9 (first floor)	Twin beds	2	Shared Jack and Jill wet room style ensuite shower room (shared with bedroom 2).
Bedroom 10 (ground floor)	Double bed (can be divided into two single beds) ●	2	Cloakroom with toilet and sink opposite. Shared family bathroom on first floor with bath and separate shower.
Total		21 (+4*)	

*There are four extra beds that can be set up by prior arrangement in any bedroom except bedrooms 4 & 9 (no additional charge).



FLOOR PLANS

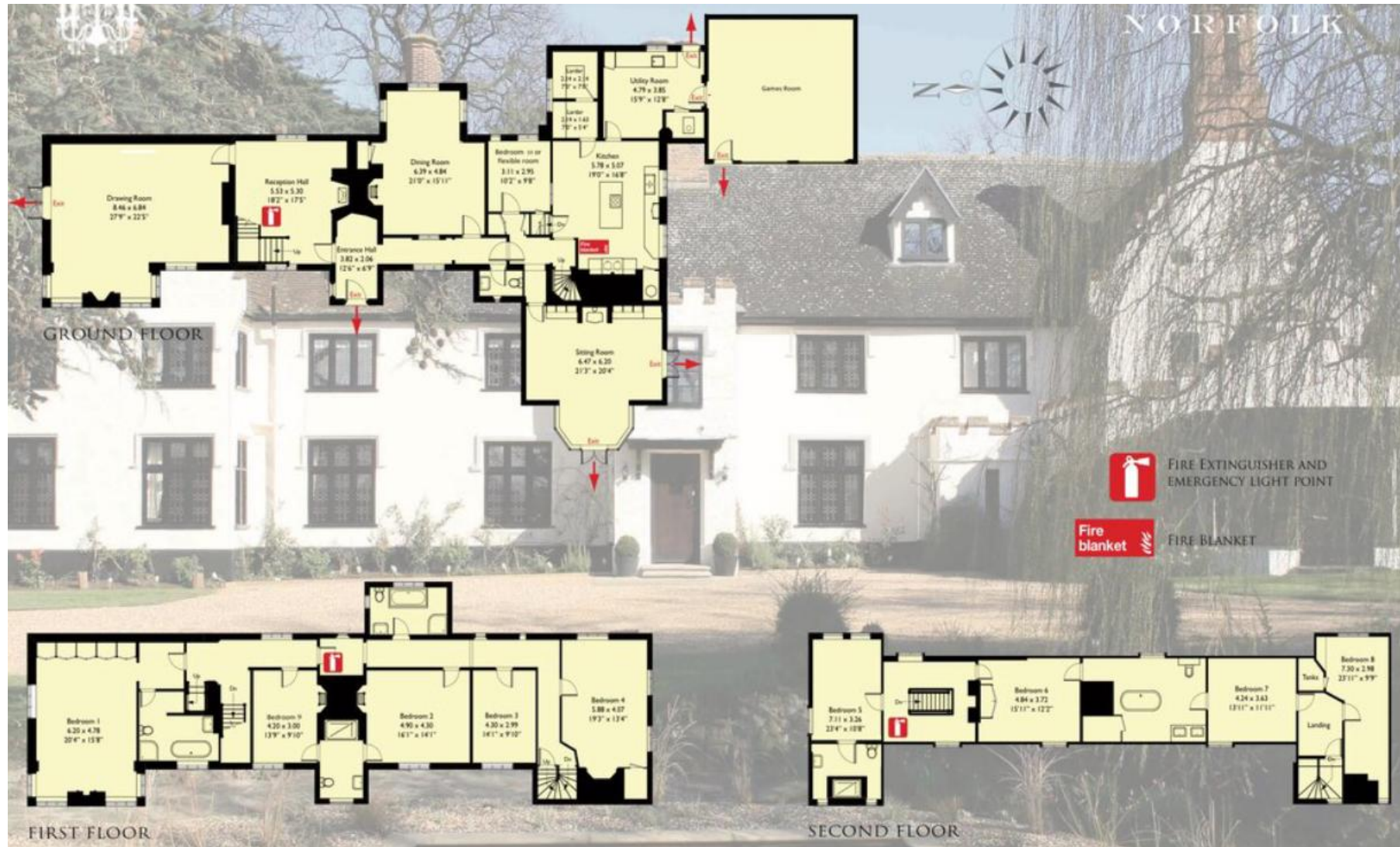

BIG HOUSE EXPERIENCE